



A legend, a dream.



ROYAL PALM
BEACHCOMBER LUXURY

*****+

FACTSHEET 2024-2025

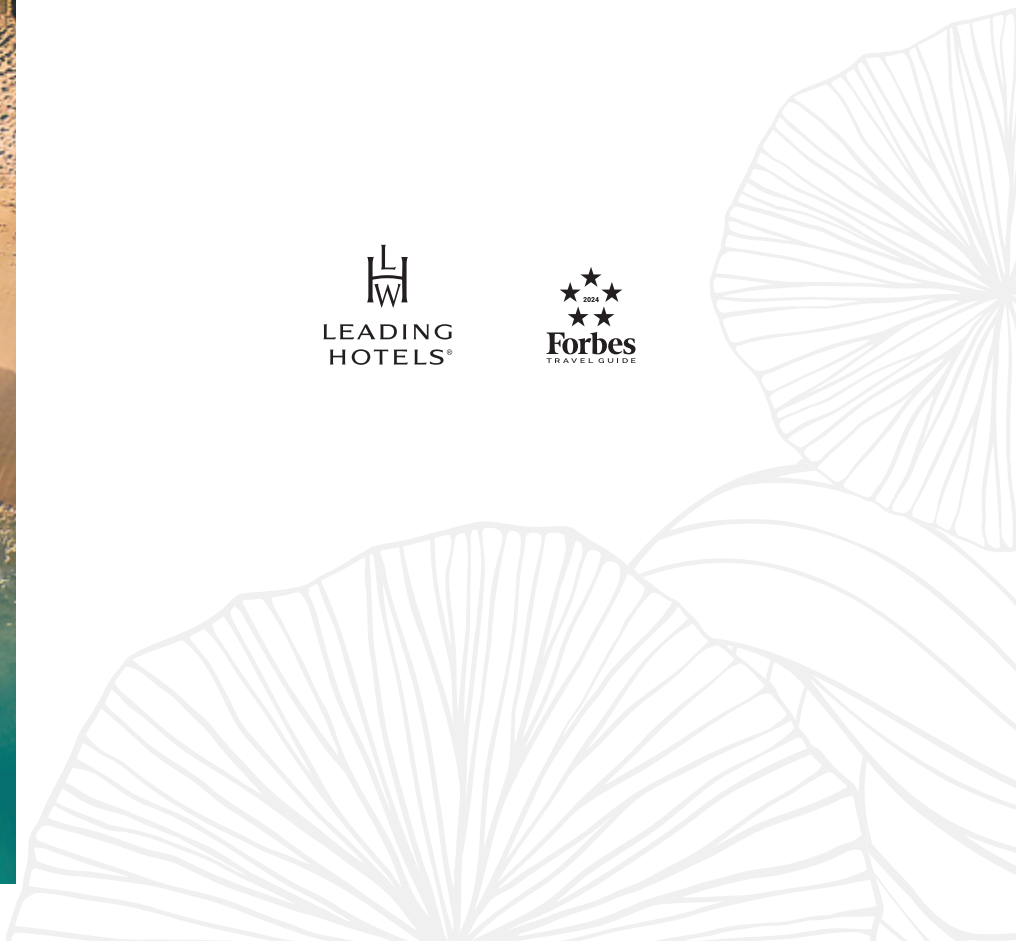

HOTEL FEATURES

A unique site on the sun-drenched north-west coast of Mauritius.

Protected from the trade winds, the sea is fringed by a pure white sandy beach.

Personalised service provided by a team of dedicated Artisans.



A member of
The Leading Hotels of the World



3 heated swimming pool
during winter



A spacious Fitness Centre
with up-to-date equipment and
professional coaches



A wide range of complimentary
activities organised at Ti Royal Kids
Club for children aged 3 to
11 years old



Helipad



4 restaurants offer a diverse
culinary experiences led by the
Executive Chef William Girard



A brand new Royal Villa
with private pool



A weekly programme of
complimentary land & water sports
and relaxation activities



Complimentary activities organized
for teens aged 12 to 17 years old



Dining interchangeability
with all Beachcomber Hotels
(upon reservation)



69 spacious, elegantly decorated
Suites facing the Indian Ocean



Royal Palm Spa in partnership
with Valmont



A range of curated wellness retreats



Access to Mont Choisy Le Golf,
a 18-hole golf course located 10 minutes
away from the resort

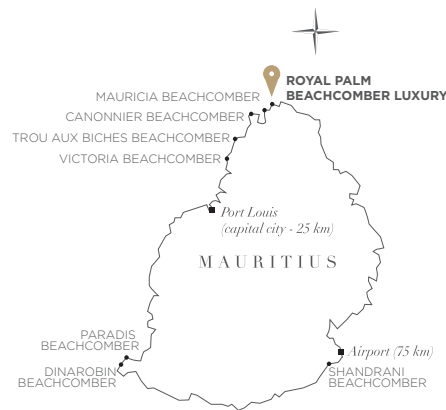

ACCOMMODATION

SUITES

Junior Suite
Max Capacity **2 adults + 1 child**
Living Area \approx **60m²**
N^o of Suites **27**

Tropical Suite
Max Capacity **2 adults + 1 child**
Living Area \approx **85m²**
N^o of Suites **4**

Ocean Suite
Max Capacity **2 adults + 2 children**
Living Area \approx **125m²**
N^o of Suites **23**

Palm Suite
Max Capacity **2 adults + 1 child**
Living Area \approx **105m²**
N^o of Suites **7**

Palm Suite Family
Max Capacity **2 adults + 2 children**
Living Area \approx **140m²**
N^o of Suites **3**

SUITES AMENITIES

All suites are seafacing and possess the following facilities:

- Bathroom with separate bathtub, shower and toilet(s)
- Walk-in wardrobe
- Terrace/ Balcony
- Individual safe
- Air-conditioning
- WI-FI access
- Flat screen TV (satellite channels)
- Telephone with international direct dialling
- Fax (on request)
- Minibar
- Tea & coffee
- Two-pin plug sockets same as South Africa; three-prong sockets are square (British)
- Penthouse:** Personal butler service
- Royal Villa & Presidential Suite:** Two separate bedrooms, 2 bathrooms, personal butler service

SUITE POLICY

- 24-hour room service
- Laundry, dry-cleaning and pressing service (service charge)
- Check-in is at 2 p.m. Check-out is at noon
- Lift located next to the reception
- One room for disabled persons on request
- Sunbed allocation with respect to room category

SIGNATURE SUITES

Penthouse
Max Capacity **2 adults + 1 child**
Living Area \approx **195m²**
N^o of Suite **1**

PRESIDENTIAL SUITES
Max Capacity **Max 4 adults.**
Living Area \approx **260m²**
N^o of Suites **3**

ROYAL VILLA
Max Capacity **Max 6 adults + 2 children.**
Living Area \approx **385m²**
N^o of Suite **1**

Various possibilities of connecting suites to accommodate families.





Highlights

PRESIDENTIAL SUITES

- A breathtaking view of the ocean
- A spacious suite; 260m² of living area, reflecting elegance and sophistication
- A large terrace featuring a lounge area, a table to enjoy alfresco meals and long chairs, facing the sea

ROYAL VILLA

- A privileged location facing the sea
- Direct access to the beach
- Own private pool
- A unique suite of 385m² with spacious and bright spaces
- A delightful gazebo ideal for moments of relaxation
- Fully renovated and newly designed

ROOM PLANS



Junior Suite



Tropical Suite



Ocean Suite



Palm Suite



Palm Suite Family



Penthouse

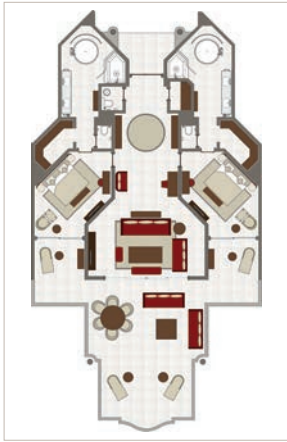

Presidential Suite



Royal Villa - Ground Floor



Royal Villa - First Floor



RESTAURANTS

LA GOÉLETTE

Signature restaurant overlooking the bay.

Breakfast Buffet / A la Carte 7.30 a.m. to 10.30 a.m.

Dinner A la Carte 7 p.m. to 10.30 p.m.

Reservation Recommended / **Seats** 80

RESTAURANT LA PLAGE

Restaurant and beach bar.

Set under a magnificent badamier tree, offering guests a relaxed and casual atmosphere.

Lunch A la Carte 12.30 p.m. to 4 p.m. / **Seats** 70

Reservation Recommended

ASIYA

Pan-Asian restaurant facing the lagoon.

Dinner A la Carte 7 p.m. to 10.30 p.m.

Reservation Recommended / **Seats** 40

GRAND SABLE

Pop-Up Mediterranean restaurant.

Open from October to April.

Dinner A la Carte 7 p.m. to 10.30 p.m.

Seats 30

Restaurant reservation requests can be sent through to pr.rp@beachcomber.com prior to arrival.

DRESS CODE

Daytime: swimwear or tank tops are not allowed.

Evening as from 7 p.m.: gentlemen are requested to wear collars, trousers and closed shoes.

Royal Grill and Grand Sable: casual

ROYAL PALM SPA

Exclusive partnership with the Swiss brand Valmont.

Extensive wellness area of 2000m² offering: 12 treatment rooms, 2 wet steam baths, 2 dry steam baths, 1 hairdressing salon (by Leonor Grey!), 2 beauty salons, 1 barber shop, 1 nail salon, 2 changing rooms, 2 locker rooms, Spa retail shop, Outdoor plunge pool, 1 yoga pavilion, Bar, Indoor/outdoor relaxing areas

Wellness Retreats*

Meditation and Energy, Silhouette and Pilates, Muscle toning, Sleep sanctuary, Timeless Beauty

*Activities involving cost

ROYAL GRILL

Signature culinary event on the beach every Thursday.

Dinner Buffet* 8 p.m. to 10.30 p.m.

Reservation Required

* Supplement applicable.

The Management reserves the right to close up some outlets per day throughout the year based on level of occupancy

BARS

LE BAR

Opens daily from 10 a.m.

LE BAR PLAGE

Opens daily from 10 a.m. to 6 p.m.

THE WINE CELLAR

Wine tasting experience according to your preferences and paired with a selection of tapas. Advance bookings required.



SPORTS & LEISURE

TENNIS

2 tennis courts

FITNESS CENTRE

1 cardio room, 1 multifunctional room, 1 strength room, 2 changing rooms

LAND SPORTS

Table tennis, bocceball, dart board, 1 squash court, mountain biking, stretching, Pilates Mat & Ball*, meditation, yoga*, Qi-Gong*

PERSONAL/GROUP COACHING*

*Activities involving cost

ENTERTAINMENT

Daily live entertainment from 7 p.m.

TI ROYAL

Housed in a spacious facility dedicated to children aged 3 to 11. Opening hours from 9 a.m. to 11 p.m.

A Babysitting service available on request with supplement (24-hour notice required).

BABY CARE AMENITIES (available on request)

TEENS

Free activity programme for teenagers aged 12-17



WATER SPORTS

Aquagym, Water Skiing, Windsurfing, Kayaking, Sailing, Glass bottom boat, Snorkelling, Stand-Up Paddle, Wakeboarding, Scuba Diving*, Private boats excursions*, Hobie Cats, Pedal boats, Kitesurf*

PRACTICAL INFORMATION

Clefs d'Or Concierge - Boutiques - WI-FI - Limousine & helicopter transfers - Doctor on call - PressReader - House florist - Courtesy rooms (according to availability) - Cigar lounge

CREDIT CARDS

American Express, Visa, Mastercard, Diners. Personal and travellers cheques are not accepted.

NON-SMOKING POLICY

All our rooms, restaurants and public areas within the hotel premises are non-smoking as per local regulations. Designated smoking areas are available.



Updated on July 2024.