



ROYAL PALM
BEACHCOMBER LUXURY

*****+

BE timeless

At Royal Palm Beachcomber Luxury, time stands still.
In this intimate palace, timeless elegance comes to life with
bespoke experiences. Immerse yourself in an atmosphere
where every experience turns into a lasting memory.



Hotel features

A unique site on the sun-drenched north-west coast of Mauritius.
Protected from the trade winds, the sea is fringed by a pure white sandy beach.
Personalised service provided by a team of dedicated Artisans.



A member of
The Leading Hotels of the World



3 restaurants offering a diversity
of culinary experiences led by
the Executive Chef William Girard



69 spacious, elegantly
decorated suites facing the
Indian Ocean



3 heated swimming pools
during winter



A brand new Royal Villa
with private pool



Royal Palm Spa in partnership
with Valmont



A spacious Fitness Centre
with up-to-date equipment and
professional coaches



A weekly programme of
complimentary land & water sports
and relaxation activities



A range of curated wellness retreats



A wide range of complimentary
activities organised at Ti Royal Kids
Club for children aged 3 to
11 years old



Complimentary activities organised
for teens aged 12 to 17 years old



Access to Mont Choisy Le Golf,
an 18-hole golf course located
10 minutes away from the resort.
Green fee is offered on a daily basis
(including transfers).



Dining interchangeability
with all Beachcomber Hotels
(upon reservation)



Helipad

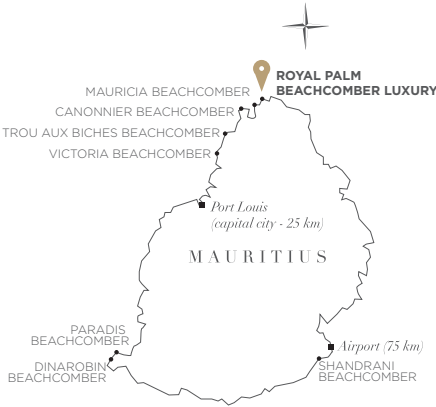

ACCOMMODATION

SUITES

Junior Suite
Max Capacity **2 adults + 1 child**
Living Area \approx **60m²**
N^o of Suites **27 (available on ground floor, 1st floor & 2nd floor)**

Tropical Suite
Max Capacity **2 adults + 1 child**
Living Area \approx **85m²**
N^o of Suites **4 (available on 1st floor)**

Ocean Suite
Max Capacity **2 adults + 2 children**
Living Area \approx **125m²**
N^o of Suites **23 (available on ground floor, 1st floor & 2nd floor)**

Palm Suite
Max Capacity **2 adults + 1 child**
Living Area \approx **105m²**
N^o of Suites **7 (available on ground floor)**

Palm Suite Family
Max Capacity **2 adults + 2 children**
Living Area \approx **140m²**
N^o of Suites **3 (available on ground floor)**

SIGNATURE SUITES

Penthouse
Max Capacity **2 adults + 1 child**
Living Area \approx **195m²**
N^o of Suite **1 (available on 2nd floor)**

PRESIDENTIAL SUITES
Max Capacity **Up to 4 pax. Max 4 adults.**
Living Area \approx **260m²**
N^o of Suites **3 (available on 2nd floor)**

ROYAL VILLA
Max Capacity **Up to 6 pax. Max 4 adults.**
Living Area \approx **385m²**
N^o of Suite **1 (available on ground floor)**

Various possibilities of connecting suites to accommodate families.

SUITES AMENITIES

All suites are sea facing and possess the following facilities:

- Bathroom with separate bath, shower and toilet(s)
- Walk-in wardrobe
- Terrace / Balcony
- Individual safe
- Air-conditioning
- WI-FI access
- Flat screen TV (satellite channels)
- Telephone with international direct dialling
- Minibar
- Tea & coffee
- Two-pin plug sockets same as South Africa; three-prong sockets are square (British)

- **Penthouse:** Personal butler service
- **Royal Villa & Presidential Suite:** Two separate bedrooms, two bathrooms, personal butler service

SUITE POLICY

- 24-hour room service
- Laundry, dry-cleaning and pressing service (service charge)
- Check-in is at 2 p.m. Check-out is at noon
- Lift located next to the reception
- One room for disabled persons on request
- Sunbed allocation with respect to room category



Highlights

PRESIDENTIAL SUITES

- A breath-taking view of the ocean
- A spacious suite; 260m² of living area, reflecting elegance and sophistication
- A large terrace featuring a lounge area, a table to enjoy alfresco meals and long chairs, facing the sea

ROYAL VILLA

- A privileged location facing the sea
- Direct access to the beach
- Own private pool
- A unique suite of 385m² with spacious and bright spaces
- A delightful gazebo ideal for moments of relaxation
- Fully renovated and newly designed
- Airport limousine transfer (roundtrip)
- Airport VIP Lounge upon arrival and departure - Jet Prime



ROOM PLANS



Junior Suite



Tropical Suite



Ocean Suite



Palm Suite



Palm Suite Family



Penthouse

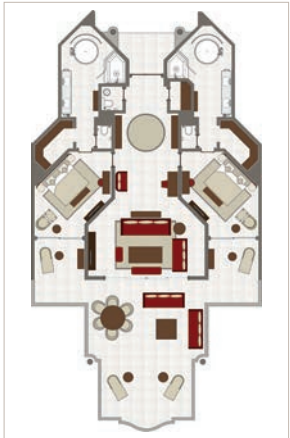

Presidential Suite



Royal Villa - Ground Floor



Royal Villa - First Floor



RESTAURANTS

LA GOÉLETTE

Signature restaurant overlooking the bay.

Breakfast Buffet / A la Carte 7.30 a.m. to 10.30 a.m.

Dinner A la Carte 7 p.m. to 10.30 p.m.

Reservation Recommended / **Seats** 80

La Table du Capitaine

This refined, intimate space is perfect for small gatherings – whether you're enjoying an aperitif, indulging in dinner or participating in a blind tasting. This A la carte dining experience is part of La Goélette's signature menu.

Reservation Recommended / **Seats** 10

RESTAURANT LA PLAGE

Restaurant and beach bar.

Set under a magnificent badamier tree, offering guests a relaxed and casual atmosphere.

Lunch A la Carte 12.30 p.m. to 4 p.m. / **Seats** 70

Reservation Recommended

ASIYA

Pan-Asian restaurant facing the lagoon.

Dinner A la Carte 7 p.m. to 10.30 p.m.

Reservation Recommended / **Seats** 40

Restaurant reservations requests can be sent through to pr.rp@beachcomber.com prior to arrival

DRESS CODE

Daytime: swimwear or tank tops are not allowed.

Evening as from 7 p.m.: gentlemen are requested to wear collars, trousers and closed shoes.

Royal Grill: casual

ROYAL PALM SPA

Exclusive partnership with the Swiss brand Valmont.

Extensive wellness area of 2000m² offering: 12 treatment rooms, 2 wet steam baths, 2 dry steam baths, 1 hairdressing salon (by Leonor Grey!), 2 beauty salons, 1 barber shop, 1 nail salon, 2 changing rooms, 2 locker rooms, Spa Retail shop, Outdoor plunge pool, 1 yoga pavilion, Bar, Indoor/outdoor relaxing areas

Wellness Retreats*

Meditation and Energy, Silhouette and Pilates, Muscle toning, Sleep sanctuary, Timeless Beauty, Detox and wellbeing

*Activities involving cost

ROYAL GRILL

Signature culinary event on the beach every Thursday.

Dinner Buffet* 8 p.m. to 10.30 p.m.

Reservation Required

*Supplement applicable on half board.

The Management reserves the right to close up some outlets per day throughout the year based on level of occupancy.

BARS

LE BAR

Opens daily from 10 a.m.

LE BAR PLAGE

Opens daily from 10 a.m. to 6 p.m.

THE WINE CELLAR

Wine tasting experience according to your preferences and paired with a selection of tapas.

Advance bookings required.



SPORTS & LEISURE

TENNIS

2 tennis courts

FITNESS CENTRE

1 cardio room, 1 multifunctional room, 1 strength room, 2 changing rooms

WATER SPORTS

Water Skiing, Windsurfing, Kayaking, Sailing, Glass bottom boat, Snorkelling, Stand-Up Paddle, Swim Board, Wakeboarding, Scuba Diving*, Private boats excursions* Snorkeling equipment is made available by the hotel for scheduled snorkelling excursions

*Activities involving cost

ENTERTAINMENT

Daily live entertainment from 7 p.m.

TI ROYAL

Housed in a spacious facility dedicated to children aged 3 to 11. Includes a small shallow pool.

Opening hours from 9 a.m. to 11 p.m.

A Babysitting service available on request with supplement (24-hour notice required).

Outdoor cinemas are only done during special occasions or festive season period (with a minimum of 50 children inhouse).

BABY CARE AMENITIES (available on request)

TEENS

Free activity programme for teenagers aged 12-17



LAND SPORTS

Table tennis, Bocciball, Dart board, 1 squash court, 1 padel court

PERSONAL/GROUP COACHING*

PRACTICAL INFORMATION

Clefs d'Or Concierge - Boutiques - WI-FI - Limousine & helicopter transfers - Doctor on call - PressReader - House florist - Courtesy rooms (according to availability) - Cigar lounge

A currency exchange desk is in Mauritius Airport's Arrivals Hall. It is recommended that clients bring their own insect repellent from home.

CREDIT CARDS

American Express, Visa, Mastercard, Diners. Personal and travellers cheques are not accepted.

NON-SMOKING POLICY

All our rooms, restaurants and public areas within the hotel premises are non-smoking as per local regulations. Designated smoking areas are available.

